





## COMPRESSION FITTINGS

<b>CONSTRUCTION</b>	<ul style="list-style-type: none"> <li>• CA360, CA3604, CA345, CA377 Brass</li> </ul> 
<b>APPLICATIONS</b>	<ul style="list-style-type: none"> <li>•Compatible with copper, brass, aluminum and thermoplastic tubing. (Thermoplastic tubing requires the use of a brass insert for support.)</li> <li>•Low pressure air, oil and water up to a maximum pressure of 400 psi.</li> <li>•Fair vibration resistance. The long nut can be used for greater vibration application.</li> </ul>
<b>RANGES</b>	<ul style="list-style-type: none"> <li>•Temperature Range: -40° F to 225° F</li> <li>•Pressure Range: Reference chart shown below.</li> </ul>  



### Compression Fitting Assembly:

1. Make sure the tubing is cut squarely with a tube cutter. After cutting, make sure the tube is clean and free of burrs.
2. Slide the nut and then the sleeve onto the tubing, thread end of the nut facing out. In the case of the threaded sleeve fitting, the nut incorporates the sleeve in a single piece.
3. Insert the tube into the fitting until it bottoms out.
4. Lubricate the threads.
5. Assemble nut to body, finger tight.
6. Tighten assembly with wrench, completing the compression of the sleeve.

### NOTES

- Fitting is supplied as an assembly. If the body only is desired, use the prefix "B".
  - Parts that include "PBF" are supplied as low lead compliant fittings.
  - Part numbers without the "PBF" distinction are NOT lead free compliant.
  - Special configuration parts are available on a quotation basis.
- 

PSI	TUBE O.D. (IN.)	TUBE WALL (IN.)
400	1/8"	.030
300	1/4"	.030
300	5/16"	.032
200	3/8"	.032
200	1/2"	.032
150	5/8"	.035
100	3/4"	.035
75	7/8"	.035

**PRESSURE RANGE @ 73°F**



<p><b>60A</b> Sleeve</p> 	<p><b>60AP</b> Delrin Sleeve</p> 	<p><b>60AE</b> Brass Insert</p> 	<p><b>61A</b> Nut</p> 
<p><b>161A</b> Long Nut</p> 	<p><b>62A</b> Union Tube</p> 	<p><b>62BH</b> Bulkhead Union</p> 	<p><b>63A</b> Check Valve</p> 
<p><b>64A</b> Union Tee</p> 	<p><b>65A</b> 90° Union Elbow</p> 	<p><b>66A</b> Female Connector</p> 	<p><b>68A</b> Male Connector</p> 
<p><b>69A</b> 90° Male Elbow</p> 	<p><b>70A</b> 90° Female Elbow</p> 	<p><b>71A</b> Male Run Tee</p> 	<p><b>72A</b> Male Branch Tee</p> 
<p><b>75A</b> Female Branch Tee</p> 	<p><b>76A</b> Street Tee</p> 	<p><b>77A</b> Female Branch Tee</p> 	<p><b>79A</b> 45° Male Elbow</p> 
<p><b>81LB</b> Control Nut</p> 	<p><b>N5CT</b> Compression Cap</p> 	<p><b>U6CC-PBF</b> M. Comp. to FM Comp.</p> 	<p><b>961A</b> Captive Sleeve</p> 



## 60A SLEEVE

PART NUMBER	O.D. TUBE
60A-2	1/8"
60A-3	3/16"
60A-4	1/4"
60A-5	5/16"
60A-6	3/8"
60A-7	7/16"
60A-8	1/2"
60A-10	5/8"
60A-12	3/4"
60A-14	7/8"



## 61A NUT

PART NUMBER	O.D. TUBE	HEX
61A-2	1/8"	3/8"
61A-3	3/16"	7/16"
61A-4	1/4"	1/2"
61A-5	5/16"	9/16"
61A-6	3/8"	5/8"
61A-7	7/16"	11/16"
61A-8	1/2"	3/4"
61A-10	5/8"	7/8"
61A-12	3/4"	1-1/8"
61A-14	7/8"	1-1/4"



## 60AP DELRIN SLEEVE

PART NUMBER	O.D. TUBE
60AP-4	1/4"
60AP-5	5/16"
60AP-6	3/8"
60AP-8	1/2"
60AP-10	5/8"



## 161A LONG NUT

PART NUMBER	O.D. TUBE	OAL	HEX
161A-2	1/8"	.50	3/8"
161A-3	3/16"	.44	7/16"
161A-4	1/4"	.75	1/2"
161A-5	5/16"	.84	9/16"
161A-6	3/8"	.97	5/8"
161A-8	1/2"	1.06	13/16"
161A-10	5/8"	1.19	15/16"
161A-12	3/4"	1.38	1-3/16"



## 60AE BRASS INSERT

PART NUMBER	O.D. TUBE
60AE-4	1/4"
60AE-5	5/16"
60AE-6	3/8"
60AE-8	1/2"
60AE-10	5/8"



## 62A UNION

PART NUMBER	O.D. TUBE	A	B	HEX
62A-22	1/8"x1/8"	1.06	.66	5/16"
62A-33	3/16"x3/16"	1.23	.75	3/8"
62A-44	1/4"x1/4"	1.21	.81	7/16"
62A-55	5/16"x5/16"	1.38	.88	1/2"
62A-66	3/8"x3/8"	1.54	.97	9/16"
62A-88	1/2"x1/2"	1.90	1.06	11/16"
62A-1010	5/8"x5/8"	1.90	1.09	13/16"
62A-1212	3/4"x3/4"	2.30	1.44	1"
62A-1414	7/8"x7/8"	2.03	1.19	1-1/8"

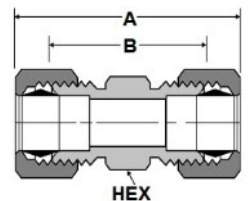



## 62BH BULKHEAD UNION

PART NUMBER	O.D. TUBE	A	B	HEX
62BH-4	1/4"	2.23	1.75	9/16"
62BH-6	3/8"	2.40	1.80	5/8"

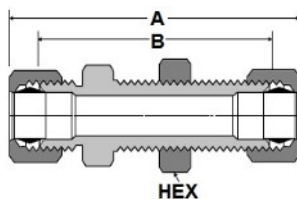

## 63A CHECK VALVE

PART NUMBER	O.D. TUBE	MPT	A	B	HEX
63A-4A	1/4"	1/8"	1.10	.88	7/16"
63A-4B	1/4"	1/4"	1.44	1.16	9/16"

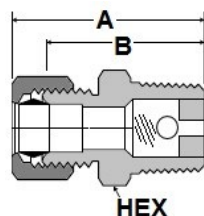

## 64A UNION TEE

PART NUMBER	O.D. TUBE	A	B
64A-22	1/8"	.82	.62
64A-33	3/16"	.84	.60
64A-44	1/4"	.86	.62
64A-55	5/16"	1.00	.73
64A-664	3/8"x1/4"	.98	.68
64A-66	3/8"	.99	.73
64A-88	1/2"	1.33	.93
64A-1010	5/8"	1.48	1.06
64A-1212	3/4"	1.69	1.25
64A-1414	7/8"	1.70	1.30

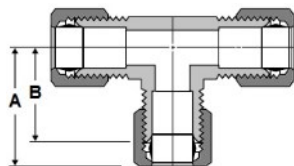

## 65A 90° UNION ELBOW

PART NUMBER	O.D. TUBE	A	B
65A-22	1/8"	.82	.62
65A-33	3/16"	.87	.63
65A-44	1/4"	.76	.52
65A-55	5/16"	.91	.65
65A-66	3/8"	1.03	.75
65A-88	1/2"	1.28	.88
65A-1010	5/8"	1.48	1.06
65A-1212	3/4"	1.62	1.18
65A-1414	7/8"	1.78	1.38

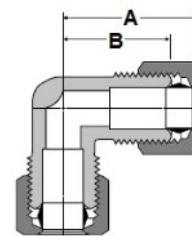

## 66A FEMALE CONNECTOR

PART NUMBER	O.D. TUBE	FPT	A	B	HEX
66A-4A	1/4"	1/8"	.94	.70	1/2"
66A-4B	1/4"	1/4"	1.12	.88	5/8"
66A-4C	1/4"	3/8"	1.24	1.00	3/4"
66A-4D	1/4"	1/2"	1.27	1.03	7/8"
66A-5A	5/16"	1/8"	1.07	.81	1/2"
66A-5B	5/16"	1/4"	1.17	.91	5/8"
66A-5C	5/16"	3/8"	1.30	1.10	3/4"
66A-6A	3/8"	1/8"	1.09	.81	9/16"
66A-6B	3/8"	1/4"	1.22	.94	5/8"
66A-6C	3/8"	3/8"	1.28	1.00	13/16"
66A-6D	3/8"	1/2"	1.34	1.03	7/8"
66A-6E	3/8"	3/4"	1.50	1.25	1-1/8"
66A-8B	1/2"	1/4"	1.49	1.09	11/16"
66A-8C	1/2"	3/8"	1.48	1.06	13/16"
66A-8D	1/2"	1/2"	1.48	1.05	7/8"
66A-8E	1/2"	3/4"	1.50	1.25	1-1/8"
66A-10C	5/8"	3/8"	1.54	1.06	13/16"
66A-10D	5/8"	1/2"	1.54	1.06	7/8"
66A-10E	5/8"	3/4"	1.64	1.16	1-1/8"
66A-12D	3/4"	1/2"	1.73	1.26	7/8"
66A-12E	3/4"	3/4"	1.82	1.28	13/16"

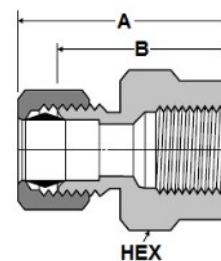



## 68A MALE CONNECTOR

PART NUMBER	O.D. TUBE	MPT	A	B	HEX
68A-2A	1/8"	1/8"	.98	.78	7/16"
68A-3A	3/16"	1/8"	1.08	.84	7/16"
68A-3B	3/16"	1/4"	1.27	1.03	9/16"
68A-4A	1/4"	1/8"	1.12	.88	9/16"
68A-4B	1/4"	1/4"	1.21	.97	9/16"
68A-4C	1/4"	3/8"	1.27	1.03	11/16"
68A-4D	1/4"	1/2"	1.27	1.00	13/16"
68A-5A	5/16"	1/8"	1.18	.91	1/2"
68A-5B	5/16"	1/4"	1.23	.97	9/16"
68A-5C	5/16"	3/8"	1.33	1.06	11/16"
68A-6A	3/8"	1/8"	1.22	.94	9/16"
68A-6B	3/8"	1/4"	1.31	1.03	9/16"
68A-6C	3/8"	3/8"	1.39	1.09	11/16"
68A-6D	3/8"	1/2"	1.32	1.06	13/16"
68A-6E	3/8"	3/4"	1.59	1.31	1-1/16"
68A-7B	7/16"	1/4"	1.39	1.06	5/8"
68A-7C	7/16"	3/8"	1.45	1.12	11/16"
68A-8B	1/2"	1/4"	1.49	1.09	11/16"
68A-8C	1/2"	3/8"	1.54	1.16	11/16"
68A-8D	1/2"	1/2"	1.49	1.09	13/16"
68A-8E	1/2"	3/4"	1.78	1.38	1-1/16"
68A-10C	5/8"	3/8"	1.54	1.12	13/16"
68A-10D	5/8"	1/2"	1.54	1.12	13/16"
68A-12D	3/4"	1/2"	1.89	1.44	1"
68A-12E	3/4"	3/4"	1.95	1.50	1-1/16"

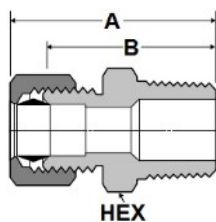

## 69A 90° MALE ELBOW

PART NUMBER	O.D. TUBE	MPT	A	B	C
69A-2A	1/8"	1/8"	.79	.59	.72
69A-3A	3/16"	1/8"	.86	.62	.72
69AF-3A	3/16"	1/8"	.86	.62	.72
69AF-3B	3/16"	1/4"	.83	.59	.81
69A-4A	1/4"	1/8"	.86	.62	.75
69AF-4A	1/4"	1/8"	.86	.62	.75
69A-4B	1/4"	1/4"	.85	.61	.81
69AF-4B	1/4"	1/4"	.86	.62	.81
69A-4C	1/4"	3/8"	.86	.62	.89
69AF-4D	1/4"	1/2"	1.07	.81	1.14
69AF-5A	5/16"	1/8"	.94	.66	.73
69AF-5B	5/16"	1/4"	.92	.66	.81
69AF-5C	5/16"	3/8"	.98	.72	.91
69A-6A	3/8"	1/8"	1.08	.80	.66
69A-6B	3/8"	1/4"	1.08	.80	.93
69AF-6B	3/8"	1/4"	1.12	.84	.73
69A-6C	3/8"	3/8"	1.05	.77	.93
69AF-6C	3/8"	3/8"	1.06	.78	.91
69A-6D	3/8"	1/2"	1.16	.88	1.12
69AF-6E	3/8"	3/4"	1.30	1.00	1.30
69AF-7B	7/16"	1/4"	1.19	.85	1.00
69A-8B	1/2"	1/4"	1.25	.88	1.03
69A-8C	1/2"	3/8"	1.25	.88	1.03
69AF-8C	1/2"	3/8"	1.25	.88	1.03
69A-8D	1/2"	1/2"	1.32	.94	1.12
69AF-8E	1/2"	3/4"	1.45	1.13	1.26
69A-10C	5/8"	3/8"	1.41	1.06	1.12
69A-10D	5/8"	1/2"	1.41	1.06	1.16
69AF-10E	5/8"	3/4"	1.45	1.16	1.26
69AF-12D	3/4"	1/2"	1.64	1.16	1.18
69AF-12E	3/4"	3/4"	1.76	1.28	1.31
69AF-14E	7/8"	3/4"	1.85	1.25	1.38

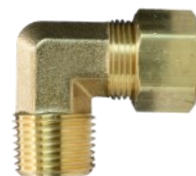
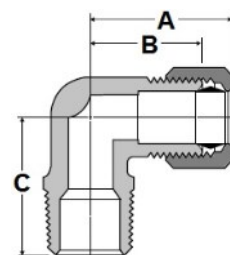

## 70A 90° FEMALE ELBOW

PART NUMBER	O.D. TUBE	FPT	A	B	C
70AF-2A	1/8"	1/8"	1.16	.94	.54
70AF-3A	3/16"	1/8"	1.26	.98	.57
70A-4A	1/4"	1/8"	.92	.68	.47
70AF-4B	1/4"	1/4"	.99	.75	.59
70AF-4C	1/4"	3/8"	1.10	.88	.54
70AF-5A	5/16"	1/8"	1.33	1.20	.82
70AF-5B	5/16"	1/4"	1.43	1.15	.50
70AF-6A	3/8"	1/8"	1.10	.75	.84
70AF-6B	3/8"	1/4"	1.13	.78	.59
70A-6C	3/8"	3/8"	1.56	1.26	.61
70A-6D	3/8"	1/2"	1.32	.97	.66
70AF-8B	1/2"	1/4"	1.82	1.49	.68
70AF-8C	1/2"	3/8"	1.53	1.19	.66
70AF-8D	1/2"	1/2"	1.89	1.53	.70
70AF-8E	1/2"	3/4"	1.89	1.53	.78
70AF-10C	5/8"	3/8"	1.70	1.20	.80
70AF-10D	5/8"	1/2"	1.41	1.03	.76
70AF-10E	5/8"	3/4"	2.12	1.85	.78
70AF-12D	3/4"	1/2"	2.29	1.80	1.24
70AF-12E	3/4"	3/4"	2.36	1.87	.92

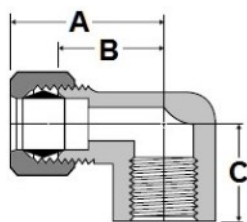

## 72A MALE BRANCH TEE

PART NUMBER	O.D. TUBE	MPT	A	B	C
72A-2A	1/8"	1/8"	.83	.61	.65
72A-3A	3/16"	1/8"	.89	.63	.70
72A-4A	1/4"	1/8"	.92	.63	.75
72A-4B	1/4"	1/4"	.98	.68	.87
72A-5A	5/16"	1/8"	.98	.75	.74
72A-5B	5/16"	1/4"	1.05	.75	.88
72A-6A	3/8"	1/8"	1.05	.75	.73
72A-6B	3/8"	1/4"	1.10	.78	.85
72A-6C	3/8"	3/8"	1.10	.78	.96
72A-8C	1/2"	3/8"	1.31	.94	1.13
72A-8D	1/2"	1/2"	1.33	.97	1.20
72A-10D	5/8"	1/2"	1.42	1.05	1.31
72A-12D	3/4"	1/2"	1.72	1.23	1.32
72A-12E	3/4"	3/4"	1.72	1.25	1.50

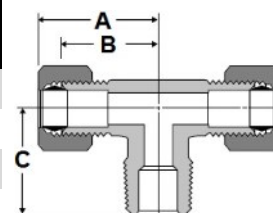

## 71A MALE RUN TEE

PART NUMBER	O.D. TUBE	MPT	A	B	C
71A-2A	1/8"	1/8"	.86	.66	.66
71A-3A	3/16"	1/8"	.88	.63	.61
71A-4A	1/4"	1/8"	.89	.64	.61
71A-4B	1/4"	1/4"	1.02	.68	.68
71A-5A	5/16"	1/8"	1.00	.73	.72
71A-5B	5/16"	1/4"	1.00	.80	.70
71A-6A	3/8"	1/8"	1.06	.75	.81
71A-6B	3/8"	1/4"	1.13	.78	.78
71A-6C	3/8"	3/8"	1.16	.81	.88
71A-8C	1/2"	3/8"	1.27	.91	.97
71A-8D	1/2"	1/2"	1.32	.97	.97
71A-10D	5/8"	1/2"	1.52	1.08	1.09
71A-12D	3/4"	1/2"	1.65	1.18	1.21

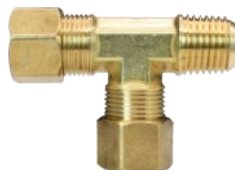
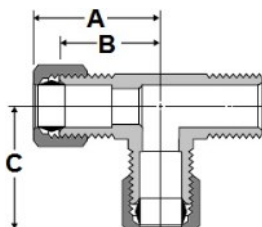

## 75A FEMALE BRANCH TEE

PART NUMBER	O.D. TUBE	PIPE THRD	A	B
75A-4A	1/4"	1/8"	.725	.614

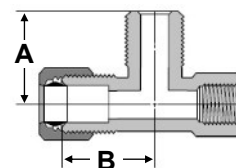

## 76A STREET COMPRESSION TEE

PART NUMBER	O.D. TUBE	PIPE THRD.	A	B	C
76A-2A	1/8"	1/8"	.85	.61	.48
76A-4A	1/4"	1/8"	.85	.57	.45
76A-4B	1/4"	1/4"	.98	.71	.98
76A-6B	3/8"	1/4"	1.09	.82	.98

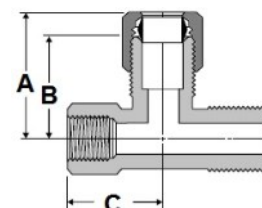





## 77A FEMALE BRANCH TEE

PART NUMBER	O.D. TUBE	FPT	A	B
77A-4A	1/4"	1/8"	1.70	1.56
77A-4B	1/4"	1/4"	1.70	1.57
77A-6A	3/8"	1/8"	1.75	1.50
77A-6B	3/8"	1/4"	1.90	1.60
77A-6C	3/8"	3/8"	1.90	1.60

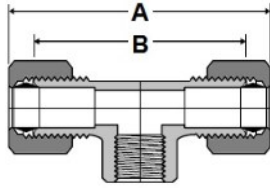

## N5CT COMPRESSION CAP

PART NUMBER	O.D. TUBE	A	HEX
N5CT-4	1/4"	.438	1/2"
N5CT-6	3/8"	.468	5/8"
N5CT-8	1/2"	.562	3/4"
N5CT-10	5/8"	.563	7/8"

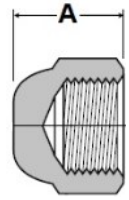

## 79A 45° MALE ELBOW

PART NUMBER	O.D. TUBE	MPT	A	B	C
79A-4A	1/4"	1/8"	.90	.66	.56
79A-6B	3/8"	1/4"	.90	.62	.84
79A-8C	1/2"	3/8"	1.14	.78	.88
79A-10D	5/8"	1/2"	1.28	.95	1.10

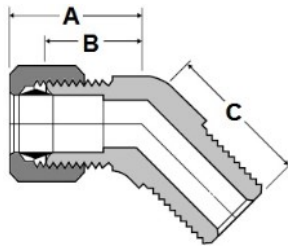

## U6CC-PBF MALE X FEMALE COMPRESSION

PART NUMBER	O.D. TUBE	A	HEX
U6CC-46-PBF	1/4"x3/8"	.88	5/8"
U6CC-67-PBF	3/8"x7/16"	.94	13/16"
U6CC-68-PBF	3/8"x1/2"	.82	13/16"

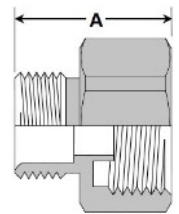

## 81LB CONTROL NUT

PART NUMBER	O.D. TUBE	A	HEX
81LB-4	1/4"	.62	7/16"

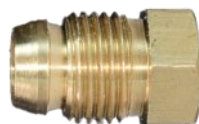
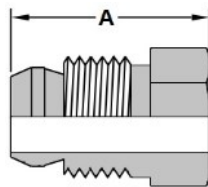

## 961A CAPTIVE SLEEVE

PART NUMBER	O.D. TUBE	A
961A-2	1/8"	.364
961A-3	3/16"	.41
961A-4	1/4"	.41
961A-5	5/16"	.44
961A-6	3/8"	.448
961A-8	1/2"	.56
961A-10	5/8"	.56
961A-12	3/4"	.68

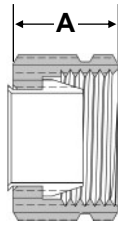

## TEMP & PRESSURE RANGES

- Temperature Range:  
-40° F to 225° F
- Pressure Range:  
Up to 800 PSI



**RANGES**

### HOW TO ORDER

To order or request pricing for the captive sleeve version of an item, add the number "9" to the start of a part number.

For example, if you'd like order part number 68A-6B with a captive sleeve compression nut/sleeve, order as:

P/N 968A-6B

