





BRASS COMPRESSION FITTINGS

CONSTRUCTION	• CA360, CA3604, CA345, CA377 Brass	
APPLICATIONS	<ul style="list-style-type: none"> •Compatible with copper, brass, aluminum and thermoplastic tubing. (Thermoplastic tubing requires the use of a brass insert for support.) •Low pressure air, oil and water up to a maximum pressure of 400 psi. •Fair vibration resistance. The long nut can be used for greater vibration application. 	
RANGES	<ul style="list-style-type: none"> •Temperature Range: -40° F to 225° F •Pressure Range: Reference chart shown below. 	 



Compression Fitting Assembly:

1. Make sure the tubing is cut squarely with a tube cutter. After cutting, make sure the tube is clean and free of burrs.
2. Slide the nut and then the sleeve onto the tubing, thread end of the nut facing out. In the case of the threaded sleeve fitting, the nut incorporates the sleeve in a single piece.
3. Insert the tube into the fitting until it bottoms out.
4. Lubricate the threads.
5. Assemble nut to body, finger tight.
6. Tighten assembly with wrench, completing the compression of the sleeve.

NOTES

- Fitting is supplied as an assembly. If the body only is desired, use the prefix "B".
- Parts that include "PBF" are supplied as low lead compliant fittings.
- Part numbers without the "PBF" distinction are NOT lead free compliant.
- Special configuration parts are available on a quotation basis.



PSI	TUBE O.D. (IN.)	TUBE WALL (IN.)
400	1/8"	.030
300	1/4"	.030
300	5/16"	.032
200	3/8"	.032
200	1/2"	.032
150	5/8"	.035
100	3/4"	.035
75	7/8"	.035

PRESSURE RANGE @ 73°F

60A Sleeve 	60AP Delrin Sleeve 	60AE Brass Insert 	61A Nut 
161A Long Nut 	62A Union Tube 	62BH Bulkhead Union 	63A Check Valve, Tube to MPT 
64A Union Tee 	65A 90° Union Elbow 	66A Female Connector 	68A Male Connector 
69A 90° Male Elbow 	70A 90° Female Elbow 	71A Male Run Tee 	72A Male Branch Tee 
76A Street Tee 	77A Female Branch Tee 	79A 45° Male Elbow 	81LB Control Nut 
N5CT Compression Cap 	U6CC-PBF M. Comp. to FM Comp. 	961A Captive Sleeve 	

BUY FROM...

THE ROBO MAN



60A SLEEVE

PART NUMBER	O.D. TUBE	A	B
60A-2	1/8"	.19	.19
60A-3	3/16"	.22	.27
60A-4	1/4"	.25	.27
60A-5	5/16"	.25	.34
60A-6	3/8"	.25	.41
60A-7	7/16"	.31	.54
60A-8	1/2"	.32	.60
60A-10	5/8"	.32	.72
60A-12	3/4"	.44	.88
60A-14	7/8"	.41	1.00

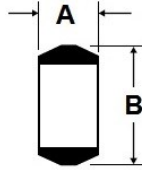

61A NUT

PART NUMBER	O.D. TUBE	A	HEX
61A-2	1/8"	.38	3/8"
61A-3	3/16"	.41	7/16"
61A-4	1/4"	.44	1/2"
61A-5	5/16"	.44	9/16"
61A-6	3/8"	.47	5/8"
61A-7	7/16"	.50	11/16"
61A-8	1/2"	.56	3/4"
61A-10	5/8"	.56	7/8"
61A-12	3/4"	.68	1-1/8"
61A-14	7/8"	.62	1-1/4"

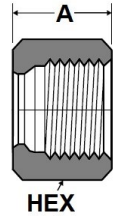

60AP DELRIN SLEEVE

PART NUMBER	O.D. TUBE	A
60AP-4	1/4"	.19
60AP-5	5/16"	.19
60AP-6	3/8"	.19
60AP-8	1/2"	.22
60AP-10	5/8"	.22

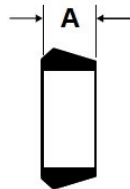

161A LONG NUT

PART NUMBER	O.D. TUBE	A	HEX
161A-2	1/8"	.50	3/8"
161A-3	3/16"	.44	7/16"
161A-4	1/4"	.75	1/2"
161A-5	5/16"	.84	9/16"
161A-6	3/8"	.97	5/8"
161A-8	1/2"	1.06	13/16"
161A-10	5/8"	1.19	15/16"
161A-12	3/4"	1.38	1-3/16"

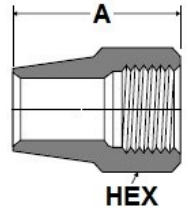

60AE BRASS INSERT

PART NUMBER	O.D. TUBE	A
60AE-4	1/4"	.65
60AE-5	5/16"	.50
60AE-6	3/8"	.54
60AE-8	1/2"	.72
60AE-10	5/8"	.62

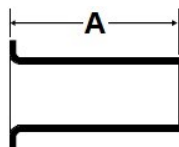

62A UNION TUBE

PART NUMBER	O.D. TUBE	A	B	HEX
62A-22	1/8"x1/8"	1.06	.66	5/16"
62A-33	3/16"x3/16"	1.23	.75	3/8"
62A-42	1/4"x1/8"	1.30	.80	7/16"
62A-43	1/4"x3/16"	1.05	.75	7/16"
62A-44	1/4"x1/4"	1.21	.81	7/16"
62A-54	5/16"x1/4"	1.31	.81	1/2"
62A-55	5/16"x5/16"	1.38	.88	1/2"
62A-64	3/8"x1/4"	1.46	.91	9/16"
62A-65	3/8"x5/16"	1.46	.91	9/16"
62A-66	3/8"x3/8"	1.54	.97	9/16"
62A-77	7/16"x7/16"	1.70	1.04	5/8"
62A-86	1/2"x3/8"	1.82	1.03	11/16"

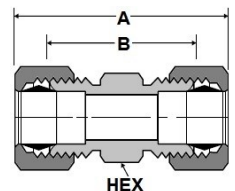

62A UNION TUBE

PART NUMBER	O.D. TUBE	A	B	HEX
62A-88	1/2"x1/2"	1.90	1.06	11/16"
62A-106	5/8"x3/8"	1.88	1.03	13/16"
62A-108	5/8"x1/2"	1.90	1.09	13/16"
62A-1010	5/8"x5/8"	1.90	1.09	13/16"
62A-1212	3/4"x3/4"	2.30	1.44	1"
62A-1414	7/8"x7/8"	2.03	1.19	1-1/8"

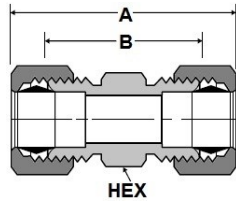

64A UNION TEE

PART NUMBER	O.D. TUBE	A	B
64A-22	1/8"	.82	.62
64A-33	3/16"	.84	.60
64A-44	1/4"	.86	.62
64A-55	5/16"	1.00	.73
64A-664	3/8"x1/4"	.98	.68
64A-66	7/16"	.99	.73
64A-88	1/2"	1.33	.93
64A-1010	5/8"	1.48	1.06
64A-1212	3/4"	1.69	1.25
64A-1414	7/8"	1.70	1.30

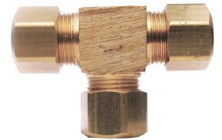
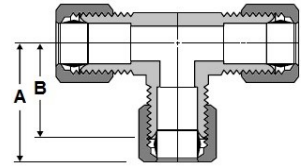

62BH BULKHEAD UNION, TUBE BOTH ENDS

PART NUMBER	O.D. TUBE	A	B	HEX
62BH-4	1/4"	2.23	1.75	9/16"
62BH-6	3/8"	2.40	1.80	5/8"

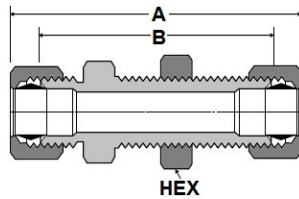

65A 90° UNION ELBOW

PART NUMBER	O.D. TUBE	A	B
65A-22	1/8"	.82	.62
65A-33	3/16"	.87	.63
65A-44	1/4"	.76	.52
65A-55	5/16"	.91	.65
65A-66	7/16"	1.03	.75
65A-88	1/2"	1.28	.88
65A-1010	5/8"	1.48	1.06
65A-1212	3/4"	1.62	1.18
65A-1414	7/8"	1.78	1.38

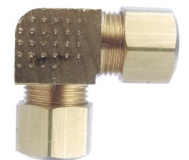
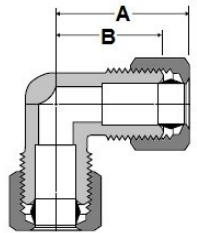

63A CHECK VALVE

PART NUMBER	O.D. TUBE	MPT	A	B	HEX
63A-4A	1/4"	1/8"	1.10	.88	7/16"
63A-6B	3/8"	1/4"	1.44	1.16	9/16"

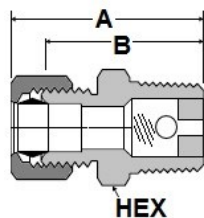

66A FEMALE CONNECTOR

PART NUMBER	O.D. TUBE	FPT	A	B	HEX
66A-4A	1/4"	1/8"	.94	.70	1/2"
66A-4B	1/4"	1/4"	1.12	.88	5/8"
66A-4C	1/4"	3/8"	1.24	1.00	3/4"
66A-4D	1/4"	1/2"	1.27	1.03	7/8"
66A-5A	5/16"	1/8"	1.07	.81	1/2"
66A-5B	5/16"	1/4"	1.17	.91	5/8"
66A-5C	5/16"	3/8"	1.30	1.10	3/4"
66A-6A	3/8"	1/8"	1.09	.81	9/16"
66A-6B	3/8"	1/4"	1.22	.94	5/8"
66A-6C	3/8"	3/8"	1.28	1.00	13/16"
66A-6D	3/8"	1/2"	1.34	1.03	7/8"

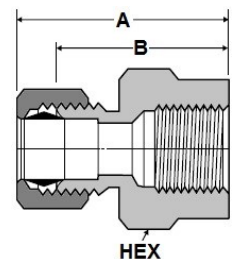

66A FEMALE CONNECTOR

PART NUMBER	O.D. TUBE	FPT	A	B	HEX
66A-6E	3/8"	3/4"	1.50	1.25	1-1/8"
66A-8B	1/2"	1/4"	1.49	1.09	11/16"
66A-8C	1/2"	3/8"	1.48	1.06	13/16"
66A-8D	1/2"	1/2"	1.48	1.05	7/8"
66A-8E	1/2"	3/4"	1.50	1.25	1-1/8"
66A-10C	5/8"	3/8"	1.54	1.06	13/16"
66A-10D	5/8"	1/2"	1.54	1.06	7/8"
66A-10E	5/8"	3/4"	1.64	1.16	1-1/8"
66A-12D	3/4"	1/2"	1.73	1.26	7/8"
66A-12E	3/4"	3/4"	1.82	1.28	13/16"

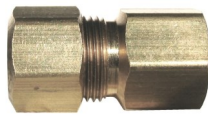
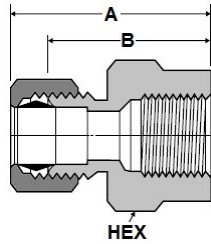

68A MALE CONNECTOR

PART NUMBER	O.D. TUBE	MPT	A	B	HEX
68A-2A	1/8"	1/8"	.98	.78	7/16"
68A-3A	3/16"	1/8"	1.08	.84	7/16"
68A-3B	3/16"	1/4"	1.27	1.03	9/16"
68A-4A	1/4"	1/8"	1.12	.88	9/16"
68A-4B	1/4"	1/4"	1.21	.97	9/16"
68A-4C	1/4"	3/8"	1.27	1.03	11/16"
68A-4D	1/4"	1/2"	1.27	1.00	13/16"
68A-5A	5/16"	1/8"	1.18	.91	1/2"
68A-5B	5/16"	1/4"	1.23	.97	9/16"
68A-5C	5/16"	3/8"	1.33	1.06	11/16"
68A-6A	3/8"	1/8"	1.22	.94	9/16"
68A-6B	3/8"	1/4"	1.31	1.03	9/16"
68A-6C	3/8"	3/8"	1.39	1.09	11/16"
68A-6D	3/8"	1/2"	1.32	1.06	13/16"
68A-6E	3/8"	3/4"	1.59	1.31	1-1/16"
68A-7B	7/16"	1/4"	1.39	1.06	5/8"
68A-7C	7/16"	3/8"	1.45	1.12	11/16"
68A-8B	1/2"	1/4"	1.49	1.09	11/16"
68A-8C	1/2"	3/8"	1.54	1.16	11/16"
68A-8D	1/2"	1/2"	1.49	1.09	13/16"
68A-8E	1/2"	3/4"	1.78	1.38	1-1/16"
68A-10C	5/8"	3/8"	1.54	1.12	13/16"
68A-10D	5/8"	1/2"	1.54	1.12	13/16"
68A-12D	3/4"	1/2"	1.89	1.44	1"
68A-12E	3/4"	3/4"	1.95	1.50	1-1/16"

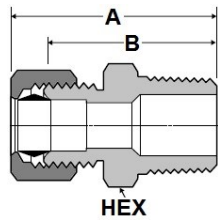

69A 90° MALE ELBOW

PART NUMBER	O.D. TUBE	MPT	A	B	C
69A-2A	1/8"	1/8"	.79	.59	.72
69A-3A	3/16"	1/8"	.86	.62	.72
69AF-3A	3/16"	1/8"	.86	.62	.72
69AF-3B	3/16"	1/4"	.83	.59	.81
69A-4A	1/4"	1/8"	.86	.62	.75
69AF-4A	1/4"	1/8"	.86	.62	.75
69A-4B	1/4"	1/4"	.85	.61	.81
69AF-4B	1/4"	1/4"	.86	.62	.81
69A-4C	1/4"	3/8"	.86	.62	.89
69AF-4D	1/4"	1/2"	1.07	.81	1.14
69AF-5A	5/16"	1/8"	.94	.66	.73
69AF-5B	5/16"	1/4"	.92	.66	.81
69AF-5C	5/16"	3/8"	.98	.72	.91
69A-6A	3/8"	1/8"	1.08	.80	.66
69A-6B	3/8"	1/4"	1.08	.80	.93
69AF-6B	3/8"	1/4"	1.12	.84	.73
69A-6C	3/8"	3/8"	1.05	.77	.93
69AF-6C	3/8"	3/8"	1.06	.78	.91
69A-6D	3/8"	1/2"	1.16	.88	1.12
69AF-6E	3/8"	3/4"	1.30	1.00	1.30
69AF-7B	7/16"	1/2"	1.19	.85	1.00
69A-8B	1/2"	1/4"	1.25	.88	1.03
69A-8C	1/2"	3/8"	1.25	.88	1.03
69AF-8C	1/2"	3/8"	1.25	.88	1.03
69A-8D	1/2"	1/2"	1.32	.94	1.12
69AF-8E	1/2"	3/4"	1.45	1.13	1.26
69A-10C	5/8"	3/8"	1.41	1.06	1.12
69A-10D	5/8"	1/2"	1.41	1.06	1.16
69AF-10E	5/8"	3/4"	1.45	1.16	1.26
69AF-12D	3/4"	1/2"	1.64	1.16	1.18
69AF-12E	3/4"	3/4"	1.76	1.28	1.31
69AF-14E	7/8"	3/4"	1.85	1.25	1.38

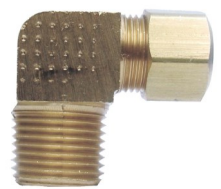
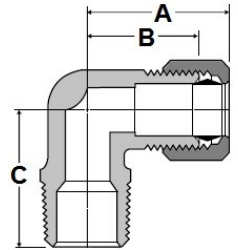

70A 90° FEMALE ELBOW

PART NUMBER	O.D. TUBE	FPT	A	B	C
70AF-2A	1/8"	1/8"	1.16	.94	.54
70AF-3A	3/16"	1/8"	1.26	.98	.57
70A-4A	1/4"	1/8"	.92	.68	.47
70AF-4B	1/4"	1/4"	.99	.75	.59
70AF-4C	1/4"	3/8"	1.10	.88	.54
70AF-5A	5/16"	1/8"	1.33	1.20	.82
70AF-5B	5/16"	1/4"	1.43	1.15	.50
70AF-6A	3/8"	1/8"	1.10	.75	.84
70AF-6B	3/8"	1/4"	1.13	.78	.59
70A-6C	3/8"	3/8"	1.56	1.26	.61
70A-6D	3/8"	1/2"	1.32	.97	.66
70AF-8B	1/2"	1/4"	1.82	1.49	.68
70AF-8C	1/2"	3/8"	1.53	1.19	.66
70AF-8D	1/2"	1/2"	1.89	1.53	.70
70AF-8E	1/2"	3/4"	1.89	1.53	.78
70AF-10C	5/8"	3/8"	1.70	1.20	.80
70AF-10D	5/8"	1/2"	1.41	1.03	.76
70AF-10E	5/8"	3/4"	2.12	1.85	.78
70AF-12D	3/4"	1/2"	2.29	1.80	1.24
70AF-12E	3/4"	3/4"	2.36	1.87	.92

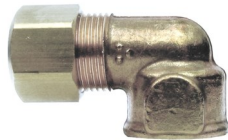
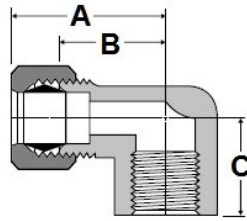

72A MALE BRANCH TEE

PART NUMBER	O.D. TUBE	MPT	A	B	C
72AF-2A	1/8"	1/8"	.83	.61	.65
72AF-3A	3/16"	1/8"	.89	.63	.70
72A-4A	1/4"	1/8"	.92	.63	.75
72A-4B	1/4"	1/4"	.98	.68	.87
72AF-5A	5/16"	1/8"	.98	.75	.74
72AF-5B	5/16"	1/4"	1.05	.75	.88
72AF-6A	3/8"	1/8"	1.05	.75	.73
72A-6B	3/8"	1/4"	1.10	.78	.85
72AF-6C	3/8"	3/8"	1.10	.78	.96
72AF-8C	1/2"	3/8"	1.31	.94	1.13
72AF-8D	1/2"	1/2"	1.33	.97	1.20
72AF-10D	5/8"	1/2"	1.42	1.05	1.31
72AF-12D	3/4"	1/2"	1.72	1.23	1.32
72AD-12E	3/4"	3/4"	1.72	1.25	1.50

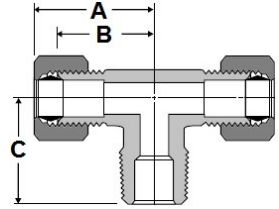

71A MALE RUN TEE

PART NUMBER	O.D. TUBE	MPT	A	B	C
71A-2A	1/8"	1/8"	.86	.66	.66
71A-3A	3/16"	1/8"	.88	.63	.61
71A-4A	1/4"	1/8"	.89	.64	.61
71A-4B	1/4"	1/4"	1.02	.68	.68
71A-5A	5/16"	1/8"	1.00	.73	.72
71A-5B	5/16"	1/4"	1.00	.80	.70
71A-6A	3/8"	1/8"	1.06	.75	.81
71A-6B	3/8"	1/4"	1.13	.78	.78
71A-6C	3/8"	3/8"	1.16	.81	.88
71A-8C	1/2"	3/8"	1.27	.91	.97
71A-8D	1/2"	1/2"	1.32	.97	.97
71A-10D	5/8"	1/2"	1.52	1.08	1.09
71A-12D	3/4"	1/2"	1.65	1.18	1.21

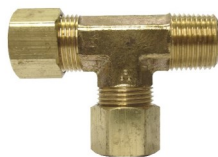
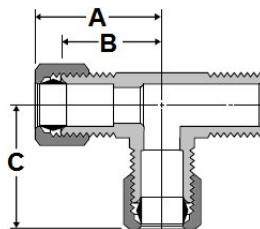

76A STREET COMPRESSION TEE

PART NUMBER	O.D. TUBE	PIPE THRD.	A	B	C
76A-2A	1/8"	1/8"	.85	.61	.48
76A-4A	1/4"	1/8"	.85	.57	.45
76A-4B	1/4"	1/4"	.98	.71	.98
76A-6B	3/8"	1/4"	1.09	.82	.98

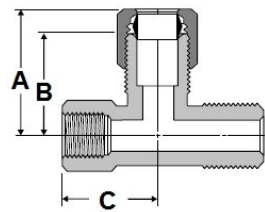

77A FEMALE BRANCH TEE

PART NUMBER	O.D. TUBE	FPT	A	B
77A-4A	1/4"	1/8"	1.70	1.56
77A-4B	1/4"	1/4"	1.70	1.57
77A-6A	3/8"	1/8"	1.75	1.50
77A-6B	3/8"	1/4"	1.90	1.60
77A-6C	3/8"	3/8"	1.90	1.60
77A-8A	1/2"	1/8"	2.20	1.90
77A-10A	5/8"	1/8"	2.50	2.13

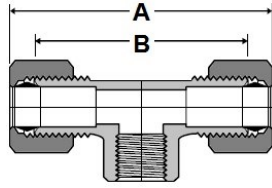

N5CT COMPRESSION CAP

PART NUMBER	O.D. TUBE	A	HEX
N5CT-4	1/4"	.438	1/2"
N5CT-6	3/8"	.468	5/8"
N5CT-8	1/2"	.562	3/4"
N5CT-10	5/8"	.563	7/8"

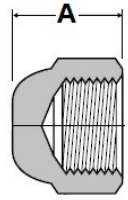

79A 45° MALE ELBOW

PART NUMBER	O.D. TUBE	MPT	A	B	C
79A-4A	1/4"	1/8"	.90	.66	.56
79A-6B	3/8"	1/4"	.90	.62	.84
79A-8C	1/2"	3/8"	1.14	.78	.88
79A-10D	5/8"	1/2"	1.28	.95	1.10

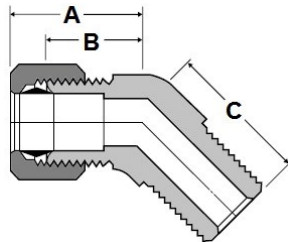

U6CC-PBF MALE X FEMALE COMPRESSION

PART NUMBER	O.D. TUBE	A	HEX
U6CC-46-PBF	1/4"x3/8"	.88	5/8"
U6CC-67-PBF	3/8"x7/16"	.94	13/16"
U6CC-68-PBF	3/8"x1/2"	.82	13/16"

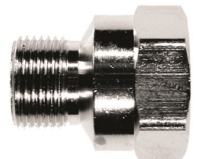
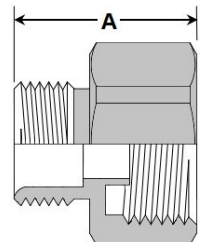

81LB CONTROL NUT

PART NUMBER	O.D. TUBE	MPT	A	B	C
79A-4A	1/4"	1/8"	.90	.66	.56
79A-6B	3/8"	1/4"	.90	.62	.84
79A-8C	1/2"	3/8"	1.14	.78	.88
79A-10D	5/8"	1/2"	1.28	.95	1.10

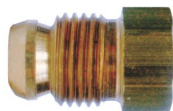
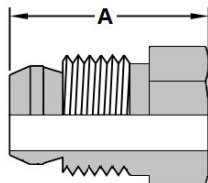

961A CAPTIVE SLEEVE

PART NUMBER	O.D. TUBE	A
961A-2	1/8"	.38
961A-3	3/16"	.41
961A-4	1/4"	.44
961A-5	5/16"	.44
961A-6	3/8"	.47
961A-8	1/2"	.56
961A-10	5/8"	.56
961A-12	3/4"	.68

